

UCFB 3-Bolt Flange Bracket Units

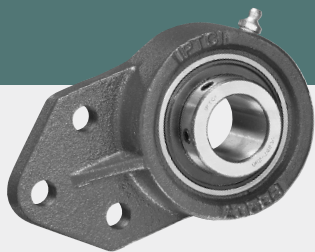

Standard duty with set screw lock.

- Cast iron housing
- Wide inner race bearing
- B-type seals
- L3-type seals available in some sizes

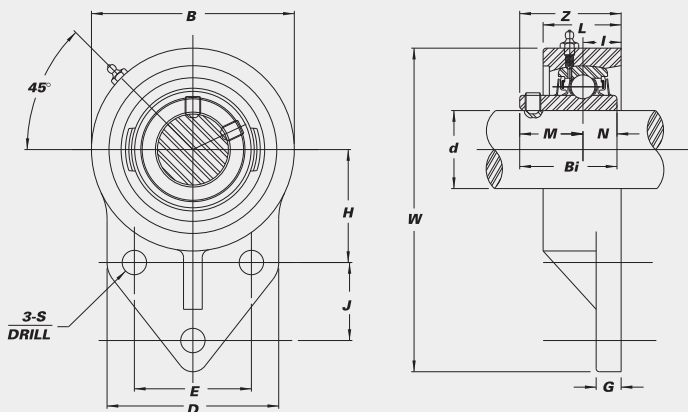
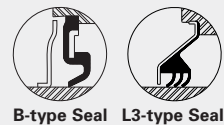

Unit No.	Shaft Dia.		Dimensions (in.) (mm)													Bolt Used (in.)	Bearing No.	Housing No.	Weight (lbs.)			
	d (in.)	d (mm)	W	B	D	L	S	G	H	J	E	I	Z	Bi	N					M		
UCFB 201		12																	UC 201			
201-8	1/2																		201-8			
202		15																	202			
202-10	5/8		4 1/4	2 1/2	2 3/8	1	25/64	5/16	1 11/16	7/8	1 1/2	5/8	1 5/16	1.2205	0.5000	0.7205	5/16		202-10	FB 204	1.5	
203		17	108	64	60	25	9.9	8	43.3	22.2	38.1	16	33.3	31.0	12.7	18.3		203				
204-12	3/4																		204-12			
204		20																	204			
UCFB 205-14	7/8																		UC 205-14			
205-15	15/16																		205-15			
205		25	4 3/4	2 3/4	2 1/2	1 1/8	25/64	3/8	1 13/16	1 1/8	1 5/8	43/64	1 13/32	1.3386	0.5630	0.7756	5/16		205	FB 205	1.5	
205-16	1		121	70	64	29	9.9	9.5	46.0	28.6	41.3	17	35.7	34.0	14.3	19.7		205-16				
UCFB 206-17	1 1/16																		UC 206-17			
206-18	1 1/8																		206-18			
206		30	5 5/8	3 1/4	2 3/4	1 1/4	25/64	3/8	2 1/16	1 1/4	1 7/8	3/4	1 37/64	1.5000	0.6260	0.8740	5/16		206	FB 206	2.0	
206-19	1 3/16		137	83	70	32	9.9	9.5	52.4	31.8	47.6	19	40.2	38.1	15.9	22.2		206-19				
206-20	1 1/4 S																		206-20			
UCFB 207-20	1 1/4																		UC 207-20			
207-21	1 5/16																		207-21			
207-22	1 3/8		6 1/8	3 3/4	3 1/4	1 7/16	33/64	1/2	2 3/8	1 1/4	2	53/64	1 3/4	1.6890	0.6890	1.0000	7/16		207-22	FB 207	2.9	
207		35	156	95	83	37	13.1	13	60.3	31.8	50.8	21	44.4	42.9	17.5	25.4		207				
207-23	1 7/16																		207-23			
UCFB 208-24	1 1/2																		UC 208-24			
208-25	1 9/16																		208-25			
208		40	6 15/32	3 15/16	3 1/16	1 11/32	7/16	5/8	2 23/64	1 39/64	1 31/32	53/64	2 1/64	1.9370	0.7480	1.1890	3/8		208	FB 208	4.0	
UCFB 209-26	1 5/8																		UC 209-26			
209-27	1 11/16																		209-27			
209-28	1 3/4		6 27/32	4 3/16	3 5/32	1 11/32	15/32	23/32	2 9/16	1 11/16	2 1/8	53/64	2 1/16	1.9370	0.7480	1.1890	3/8		209-28	FB 209	4.4	
209		45	174	106	80	34	11.9	18	65	42.9	54.0	21	52.2	49.2	19.0	30.2		209				
UCFB 210-30	1 7/8																		UC 210-30			
210-31	1 5/16																		210-31			
210		50	7 1/2	4 5/8	4	1 1/2	33/64	1/2	2 15/16	1 5/8	2 3/4	53/64	2 5/32	2.0315	0.7480	1.2835	7/16		210	FB 210	5.1	
210-32	2 S		191	118	102	38	13.1	13	74.6	41.3	69.9	21	54.6	51.6	19.0	32.6		210-32				

Interchange Page 47