

Browning®

Mounted Ball Bearings

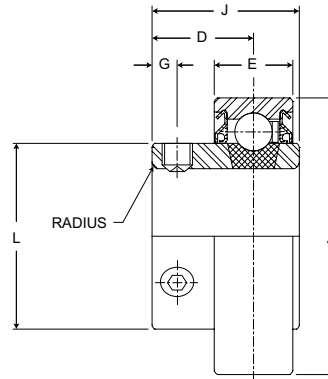

Duty: Light
Rolling Elements: Ball
Outer: Cylindrical O.D.
Self Alignment: +/- 1.5 Degrees
Lock: Setscrew
Seal: Contact
Temperature: -20° to 200°F
Relube: No



SLS 100 Series Light Duty Straight OD Inserts - Setscrew Locking

| Bore Diameter inch | Part No. | Basic Dynamic Rating lb/N | Dimensions inch / mm | | | | | | Max. Rad. To Clear | Setscrew Thread | Unit Wt. lb/kg |
|-----------------------|----------|------------------------------|----------------------|---------------|---------------|-------------|-----------------|----------------|--------------------|-----------------|----------------|
| | | | A | D | E | G | J | L | | | |
| 1/2 | SLS-108 | 2108 | 1.5748 | 5/8 | 33/64 | 5/32 | 15/16 | 31/32 | .055 | 10-32 | .4 |
| 5/8 | SLS-110 | 9377 | 40 | 15.9 | 13.1 | 4.0 | 23.8 | 24.6 | 1.4 | | .18 |
| 3/4 | SLS-112 | 2611 11614 | 1.8504 47 | 23/32 18.3 | 19/32 15.1 | 3/16 4.8 | 1 1/16 27.0 | 1 3/16 30.2 | 0.07 1.8 | 1/4-28 | .5 .23 |
| 7/8 | SLS-114 | 2801 | 2.042 | 49/64 | 19/32 | 3/16 | 1 7/64 | 1 3/8 | 0.07 | 1/4-28 | .6 |
| 15/16 | SLS-115 | 12459 | 52 | 19.4 | 15.1 | 4.8 | 28.2 | 34.9 | 1.8 | | .27 |
| 1 | SLS-116 | | | | | | | | | | |
| 1 1/8 | SLS-118 | 4381 | 2.4409 | 25/32 | 45/64 | 7/32 | 1 5/32 | 1 19/32 | 0.08 | 1/4-28 | 1.0 |
| 1 3/16 | SLS-119 | 19487 | 62 | 19.8 | 17.9 | 5.6 | 29.4 | 40.5 | 2.0 | | .45 |
| 1 1/4 | SLS-120S | | | | | | | | | | |
| 1 1/4 | SLS-120 | 5782 | 2.8346 | 55/64 | 3/4 | 1/4 | 1 9/32 | 1 55/64 | 0.08 | 5/16-24 | 1.6 |
| 1 3/8 | SLS-122 | 25718 | 72 | 21.8 | 19.1 | 6.4 | 32.5 | 47.2 | 2.0 | | .73 |
| 1 7/16 | SLS-123 | | | | | | | | | | |
| 1 1/2 | SLS-124 | 7340 32648 | 3.1496 80 | 15/16 23.8 | 55/64 21.8 | 9/32 7.1 | 1 27/64 36.1 | 2 1/16 52.4 | 0.095 2.4 | 5/16-24 | 1.8 .82 |

Outside diameter may be oversized due to seal press fit.

Metric dimensions for reference only.

Not all parts are available from stock. Please contact customer service for availability (800) 626-2120.

For more information on bearing capabilities outside of our standard offering, please contact Application Engineering (800) 626-2093.