

BALDOR® • RELIANCE 

Product Information Packet

OF3307T

7.5HP, 1125RPM, 3PH, 60HZ, 254T, 3930M, OPSB

Part Detail							
Revision:	AE	Status:	PRD/A	Change #:		Proprietary:	No
Type:	AC	Elec. Spec:	39GW460	CD Diagram:	CD0321	Mfg Plant:	
Mech. Spec:	39L21	Layout:	39LYL021	Poles:	06	Created Date:	
Base:	RG	Eff. Date:	09-07-2018	Leads:	12#12 ML4400b12		Y

Specs			
Catalog Number:	OF3307T	Heater Indicator:	No Heater
Enclosure:	OPSB	Insulation Class:	F
Frame:	254T	Inverter Code:	Not Inverter
Frame Material:	Steel	KVA Code:	H
Output @ Frequency:	7.500 HP @ 60 HZ	Lifting Lugs:	Standard Lifting Lugs
Synchronous Speed @ Frequency:	1200 RPM @ 60 HZ	Locked Bearing Indicator:	Locked Bearing
Voltage @ Frequency:	230.0 V @ 60 HZ	Motor Lead Quantity/Wire Size:	12 @ 12 AWG
	460.0 V @ 60 HZ	Motor Lead Exit:	Ko Box
	796.0 V @ 60 HZ	Motor Lead Termination:	Flying Leads
XP Class and Group:	None	Motor Type:	3930M
XP Division:	Not Applicable	Mounting Arrangement:	F2
Agency Approvals:	UR	Power Factor:	69
	CSA	Product Family:	Oil Field Pump Motors(Not DC)
Auxillary Box:	No Auxillary Box	Pulley End Bearing Type:	Ball
Auxillary Box Lead Termination:	None	Pulley Face Code:	Standard
Base Indicator:	Rigid	Pulley Shaft Indicator:	Standard
Bearing Grease Type:	Polyrex EM (-20F +300F)	Rodent Screen:	Included
Blower:	None	Shaft Extension Location:	Pulley End

Current @ Voltage:	12.400 A @ 460.0 V	Shaft Ground Indicator:	No Shaft Grounding
	24.800 A @ 230.0 V	Shaft Rotation:	Reversible
	7.200 A @ 796.0 V	Shaft Slinger Indicator:	No Slinger
Design Code:	D	Speed Code:	Single Speed
Drip Cover:	No Drip Cover	Motor Standards:	NEMA
Duty Rating:	CONT	Starting Method:	Direct on line
Electrically Isolated Bearing:	Not Electrically Isolated	Thermal Device - Bearing:	NONE (OLD)
Feedback Device:	NO FEEDBACK	Thermal Device - Winding:	Normally Closed Thermostat
Front Face Code:	Standard	Vibration Sensor Indicator:	No Vibration Sensor
Front Shaft Indicator:	None	Winding Thermal 1:	None
		Winding Thermal 2:	None

Nameplate NP2961E											
CAT.NO.											
SPEC.	39L21W460										
HP	7.5										
VOLTS	230/460/796										
AMP	24.8/12.4/7.2										
RPM	1125										
FRAME	254T				HZ	60		PH	3		
SER.F.	1.00			CODE	H		DES	D		CLASS	F
NEMA-NOM-EFF	81.5			PF	69						
RATING	40C AMB-CONT										
CC								USABLE AT 208V			
DE	6309				ODE	6309					
ENCL	OPSB			SN							

Parts List		
Part Number	Description	Quantity
SA000531	SA 39L21W460	1.000 EA
RA000531	RA 39L21W460	1.000 EA
HA6361A01	LIFTING LUG FOR 37, 39 & 40 FRAME ZINC	2.000 EA
HA6016	ADAPTER, CAST CONDUIT BOX	1.000 EA
09CB1001A31	CONDUIT BOX, MACH 309 FRAME	1.000 EA
09GS1017	GASKET, CONDUIT BOX, .125 THICK BLACK NE	1.000 EA
51XW2520A12	.25-20 X .75, TAPTITE II, HEX WSHR SLTD	2.000 EA
HW1001A25	LOCKWASHER 1/4, ZINC PLT .493 OD, .255 I	2.000 EA
WD1000B17	T&B CX35TN TERMINAL	1.000 EA
10XN2520K08	1/4-20 X .50 GRADE #5, STL, ZINC PLATE	1.000 EA
HW1001A25	LOCKWASHER 1/4, ZINC PLT .493 OD, .255 I	1.000 EA
39EP1200A02	FR ENDPLATE, MACH	1.000 EA
HA4051A00	PLASTIC CAP FOR GREASE FITTING	1.000 EA
HA1103A01	RODENT SCREEN,309 FRAME, OPEN	1.000 EA
12XN0832A12	8-32 X 3/4 HEX HD SCREW	2.000 EA
XY0832A02	8-32 HEX NUT	2.000 EA
12XN0832A12	8-32 X 3/4 HEX HD SCREW	2.000 EA
XY0832A02	8-32 HEX NUT	2.000 EA
HW1000A08	#8 SAE FLAT WASHER	2.000 EA
12XN0832A06	8-32 X 3/8 HEX HD SCREW	1.000 EA
HW1000A08	#8 SAE FLAT WASHER	1.000 EA
HW5100A11	W3917-042 WVY WSHR (WB)	1.000 EA
10XN2520K28	1/4-20 X 1.75" HX HD SCRWGRADE 5, ZINC P	4.000 EA
HW1001A25	LOCKWASHER 1/4, ZINC PLT .493 OD, .255 I	4.000 EA

Parts List (continued)		
Part Number	Description	Quantity
39EP1200A06	ENDPLATE MACH	1.000 EA
HA4051A00	PLASTIC CAP FOR GREASE FITTING	1.000 EA
HA1103A01	RODENT SCREEN,309 FRAME, OPEN	1.000 EA
HW1000A08	#8 SAE FLAT WASHER	2.000 EA
12XN0832A06	8-32 X 3/8 HEX HD SCREW	1.000 EA
HW1000A08	#8 SAE FLAT WASHER	1.000 EA
XY3816A12	3/8-16 FINISHED NUT	8.000 EA
09CB1501A01	CONDUIT BOX LID, MACH	1.000 EA
09GS1001A01	GASKET, BOX LID, 1/8 THICK BLACK NEOPREN	1.000 EA
10XN2520K16	1/4-20 X 1" HX HD SCRW GRADE 5, ZINC P	2.000 EA
HW1001A25	LOCKWASHER 1/4, ZINC PLT .493 OD, .255 I	2.000 EA
HW2501G25	KEY, 3/8 SQ X 2.875	1.000 EA
LB1115N	LABEL,LIFTING DEVICE (ON ROLLS)	1.000 EA
HW4500A03	GREASE FITTING, .125 NPT 1610(ALEMITE) 8	1.000 EA
HW4500A17	317400 ALEMITE GREASE RELIEF	1.000 EA
MJ1000A02	GREASE, POLYREX EM EXXON (USe 4824-15A)	0.030 LB
HW4500A03	GREASE FITTING, .125 NPT 1610(ALEMITE) 8	1.000 EA
HW4500A17	317400 ALEMITE GREASE RELIEF	1.000 EA
MG1025G03	WILKOFAS, 789.901, OIL RIG SILVER	0.035 GA
85XU0407S04	4X1/4 U DRIVE PIN STAINLESS	2.000 EA
39AD2002B01	BAFFLE PLATE 39 OPEN, SLOTTED BAND MTRS	2.000 EA
HA3154A09	TB STUD 3/8-16 X 16.25	4.000 EA
LB1119N	WARNING LABEL	1.000 EA
NP2961E	ALUM CSA CC	1.000 EA

Product Information Packet: OF3307T - 7.5HP,1125RPM,3PH,60HZ,254T,3930M,OPSB

LC0321	CONNECTION LABEL	1.000 EA
39PA1000	PACKAGING GROUP 39 PRINT	1.000 EA
MN416A01	TAG-INSTAL-MAINT no wire (1200/bx) 5/18	4.000 EA
LB1417	LABEL CARTON 6X4 PERFORATED BLANK ROLLS	1.000 EA

AC Induction Motor Performance Data

Record # 12760 - Typical performance - not guaranteed values

Winding: 39WGW460-R001	Type: 3930M	Enclosure: OPEN
-------------------------------	--------------------	------------------------

Nameplate Data				460 V, 60 Hz: 2nd Voltage Connection	
Rated Output (HP)	7.5			Full Load Torque	34.9 LB-FT
Volts	230/460/796			Start Configuration	direct on line
Full Load Amps	24.8/12.4/7.2			Breakdown Torque	107 LB-FT
R.P.M.	1125			Pull-up Torque	85 LB-FT
Hz	60	Phase	3	Locked-rotor Torque	91 LB-FT
NEMA Design Code	D	KVA Code	H	Starting Current	58.3 A
Service Factor (S.F.)	1			No-load Current	8.6 A
NEMA Nom. Eff.	81.5	Power Factor	69	Line-line Res. @ 25°C	1.65 Ω
Rating - Duty	40C AMB-CONT			Temp. Rise @ Rated Load	61°C
S.F. Amps				Temp. Rise @ S.F. Load	74°C

Load Characteristics 460 V, 60 Hz, 7.5 HP

% of Rated Load	25	50	75	100	125	150	S.F.
Power Factor	29	46	59	67	72	75	70
Efficiency	70	78.8	80.7	80.4	78.7	76.3	79.4
Speed	1182	1164	1144	1123	1098	1072	1108
Line amperes	8.84	9.75	11	12.7	14.7	17	13.9

Performance Graph at 460V, 60Hz, 7.5HP Typical performance - Not guaranteed values

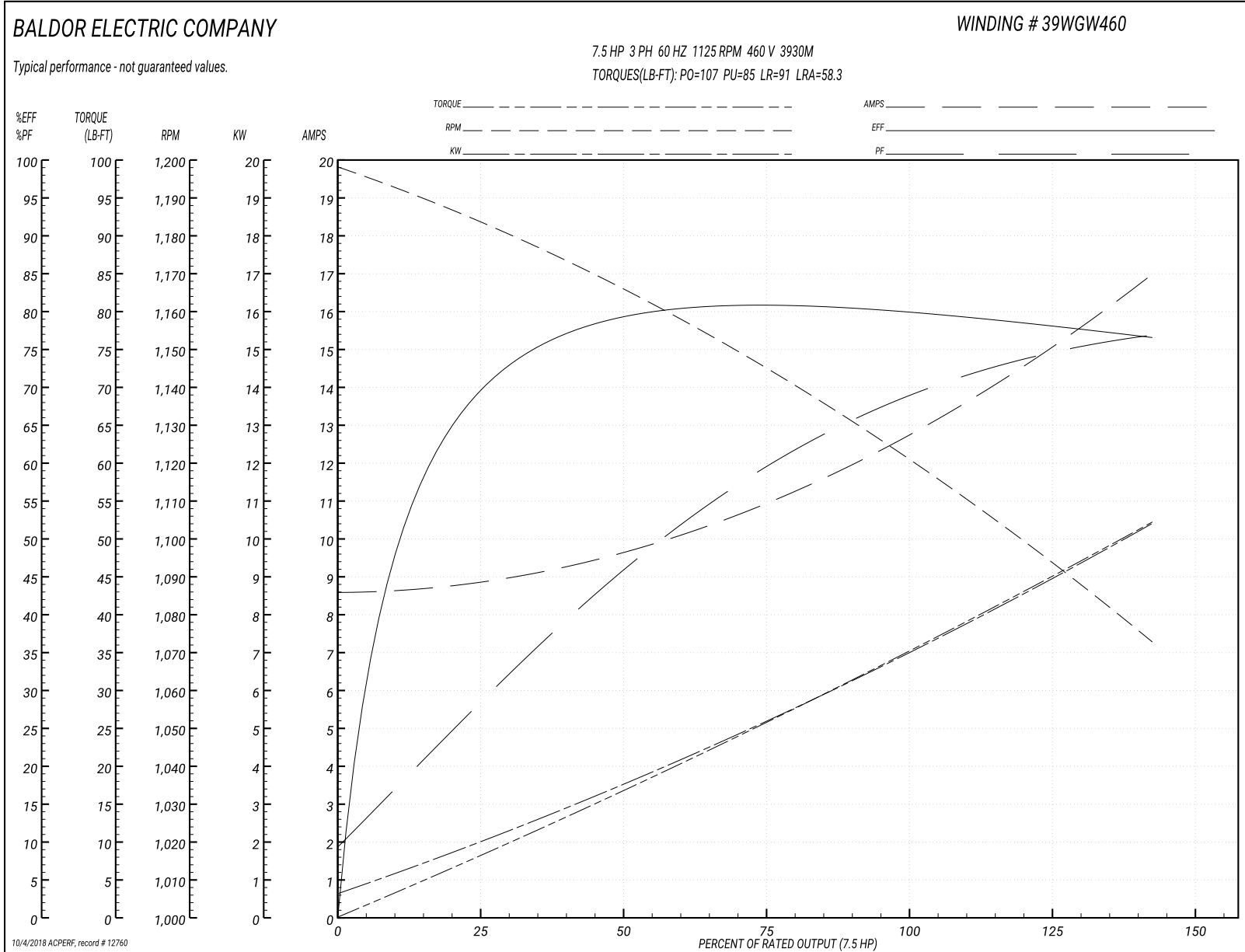

39LYL021

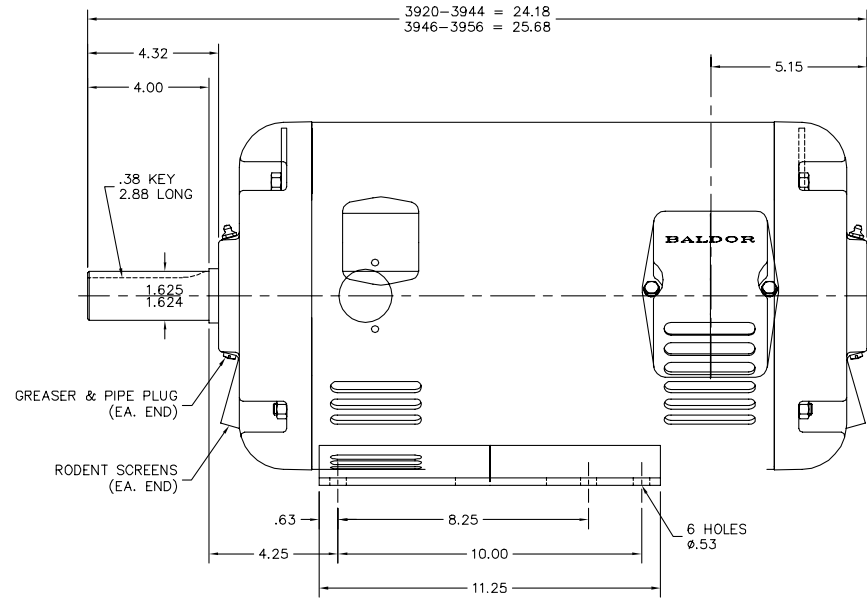
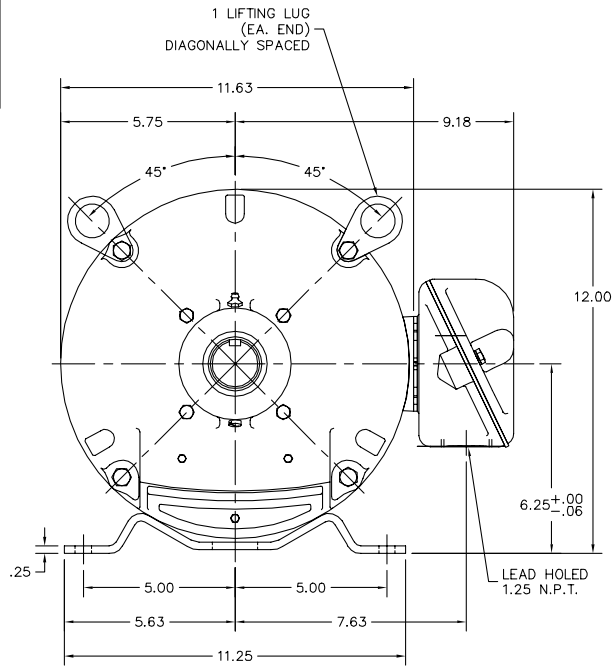

39LYL021

CUSTOMER IS RESPONSIBLE FOR DETERMINING THAT BALDOR'S PRODUCT WILL PERFORM SUITABLY IN THE INTENDED APPLICATION.

REV. DESC: UPDATED DESCRIPTION		
REV. LTR: H	VERSION: 05	TDR: 000000854908
FILE: \AAA\00013\077	REVISED: 02:27:35 05/22/2014	BY: ENNINDO
MTL: -		

BALDOR
 HORZ OPEN 254-6T F2 OFF MOTOR
 SH 1 of 1

CD0321

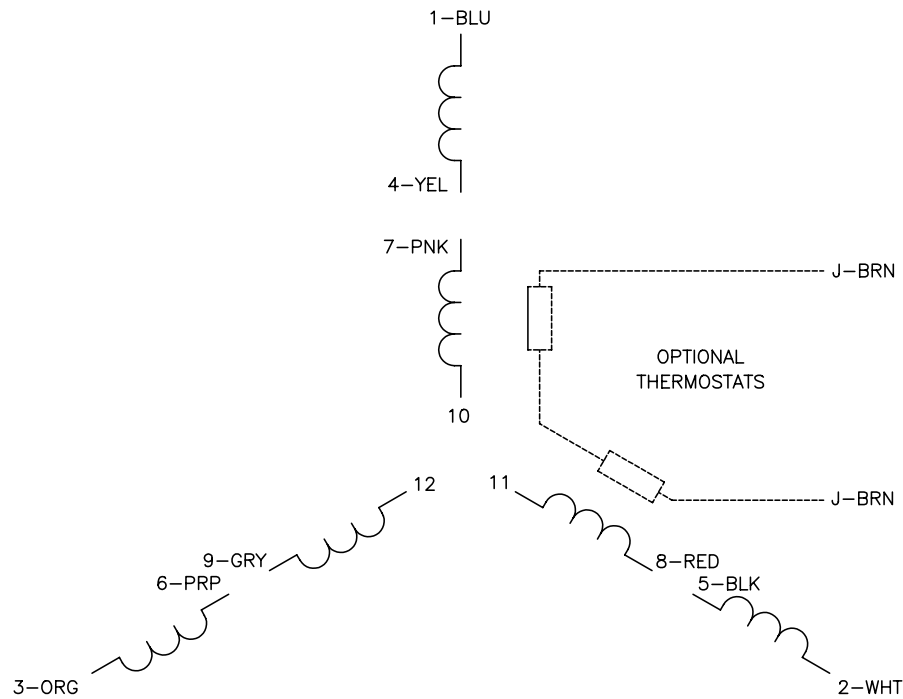

230V CONNECTION
(2D)

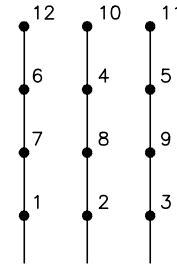

LINE

460V CONNECTION
(1D)

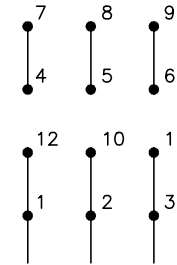

LINE

796V CONNECTION
(1Y)

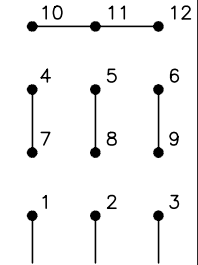

LINE

NOTES:

1. INTERCHANGE ANY TWO LINE LEADS TO REVERSE ROTATION.
2. OPTIONAL THERMOSTATS ARE PROVIDED WHEN SPECIFIED.
3. ACTUAL NUMBER OF INTERNAL PARALLEL CIRCUITS MAY BE A MULTIPLE OF THOSE SHOWN ABOVE.
4. LEAD COLORS ARE OPTIONAL. LEADS MUST ALWAYS BE MARKED AS SHOWN.

REV. DESC: REVISE TO SHOW OPTIONAL COLORS			
REV. LTR: C	BY: JLP	REVISED: 01/21/99 3:17	TDR: 0171435
CD0321		FILE: AAA00008378	MDL: -
		MTL: -	

BALDOR ELECTRIC Co.

3PH, TV, 12 LEADS, 2D/1D/1Y, OIL FIELD PUMPERS

CD0321