

NOTES:
 FINISH – GRAY BAKED ENAMEL POWDER COAT PAINT OVER CLEANED GALVANNEALED STEEL.
 UL LISTED – FILE E-10582, VOL. M, E-131840, VOL. M
 SUITABLE FOR USE AS SERVICE EQUIPMENT.
 MAIN HORIZONTAL CROSS BUS RATED 800A (ALUMINUM 1/4 X 1 3/4 TWO LAMINATIONS).
 MAIN DEVICES ARE SEALABLE BY UTILITY.
 GANGABLE MULTI-METERING EQUIPMENT IS DESIGNED FOR WALL MOUNTING ONLY
 (NOT SUITABLE FOR FLOOR STANDING EQUIPMENT).
 WHEN USED AS SERVICE EQUIPMENT, INSTALL BONDING STRAP AND REINSTALL GROUND
 LUG WHERE APPROPRIATE.

ADDITIONAL NOTES:

- HANDLE EXTENSION AVAILABLE M-FRAME BREAKER ORDER KIT 33195.
- ◆ ALTERNATE LUG KITS ARE AVAILABLE FOR USE ON LINE SIDE OF MOLDED CASE CIRCUIT BREAKER (REFER TO DIGEST 177, PAGE 7-64)
- ▼ ALTERNATE NEUTRAL LUG AVAILABLE , ORDER ONE (1) KIT , MMLK250 FOR (1) # 1/0 AWG-600 KCMIL OR (2) # 1/0 AWG – 250 KCMIL AL/CU (KIT INCLUDES THREE , 2 –BARREL LUGS), NEUTRAL WILL ACCOMODATE TWO , 2 BARREL LUGS ONLY

SYMBOL	KNOCKOUTS	
	CONDUIT SIZE	
	IN	MM
A	.50	13
B	.75	19
E	1.50	38
F	2.00	51
G	2.50	64
H	3.00	76
I	3.50	89
J	4.00	102

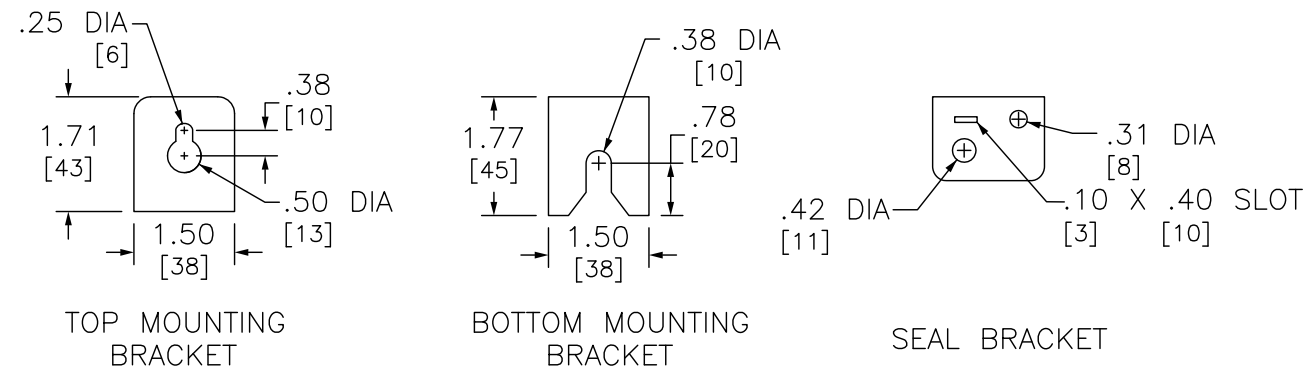
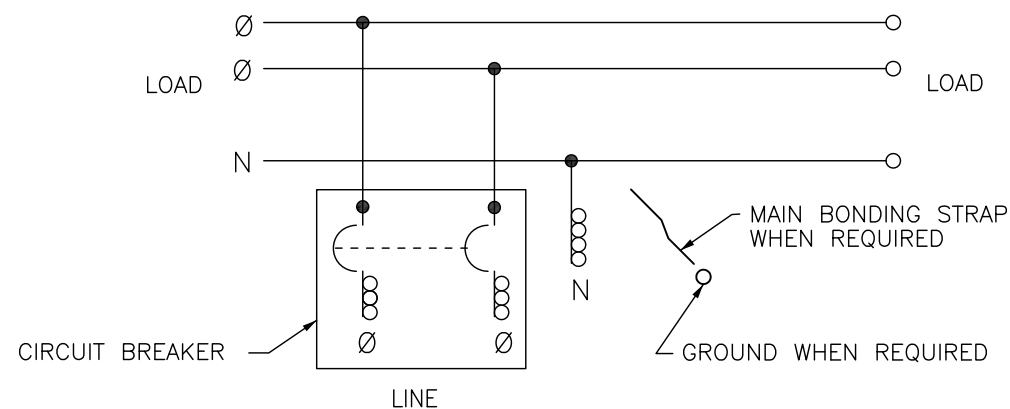

DUAL DIMENSIONS: INCHES
MILLIMETERS

SYSTEM TYPE	MAIN RATING (AMPERES)	CATALOG NUMBER	MOLDED CIRCUIT BREAKER (FACTORY INSTALLED)	LINE SIDE PHASE LUG WIRE RANGE FOR AL OR CU CONDUCTORS (SUPPLIED WITH BREAKER)	LINE SIDE NEUTRAL LUG WIRE RANGE FOR AL OR CU CONDUCTORS (FACTORY INSTALLED)	GROUND LUG WIRE RANGE (FACTORY INSTALLED)
1Ø 3W 120/240VAC	600	EZM1600CB	MGP26600 (65kA)	(3) 3/0-500 ◆	(4) 3/0-500 ▼	(1) #6-300
	800	EZM1800CB	MGP26800 (65kA)	(3) 3/0-500 ◆	(4) 3/0-500 ▼	(1) #6-300

EZ METER-PAK GANGABLE
 MULTI-METERING EQUIPMENT
 1600A 3PH 4W MAIN CIRCUIT BREAKER DEVICE W/ERMS
 OVERHEAD/UNDERGROUND FEED
 RAINPROOF TYPE 3R ENCLOSURES

SQUARE D™
 by Schneider Electric

DWG# PWFDS-SYRS-0173
 NO.