

Thermoplastic Pillow Blocks

With optional bearing inserts:
Stainless Steel-SUCTP
Hard Chrome Coated-CUCTP
Black Oxide-BUCTP



B-type Seal

- B-type seal
- End Caps Available
- Overview of corrosion resistant products - pg. 52

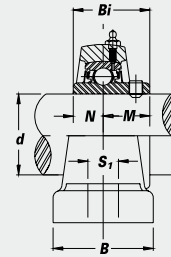
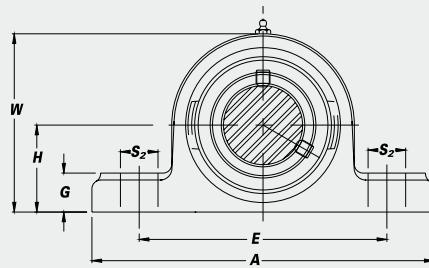

CORROSION RESISTANT

Unit No.	Shaft Dia.		Dimensions (in.) (mm)										Bolt Used (in.)	Bearing No.	Housing No.	Weight (lbs.)
	d (in.)	d (mm)	H	A	E	B	S ₂	S ₁	G	W	Bi	N				

SUCTP with Stainless Steel Bearing Inserts

SUCTP 201-8	1/2																SUC 201-8		
202-10	5/8		1 5/16	5	3 3/4	1 1/2	9/16	7/16	9/16	2 19/32	1.2205	0.5000	0.7205	3/8			202-10	TP 204	.8
204-12	3/4		33.3	127	95	38	14	11	14	66	31.0	12.7	18.3				204-12		
204		20															204		
SUCTP 205-14	7/8																SUC 205-14		
205		25	1 7/16	5 1/2	4 1/8	1 1/2	9/16	7/16	9/16	2 13/16	1.3386	0.5630	0.7756	3/8			205	TP 205	.8
205-16	1		36.5	140	105	38	14	11	14	71	34.0	14.3	19.7				205-16		
SUCTP 206-18	1 1/8																SUC 206-18		
206		30	1 11/16	6 13/32	4 11/16	1 13/16	23/32	9/16	11/16	3 19/64	1.5000	0.6260	0.8740	1/2			206	TP 206	1.2
206-19	1 3/16		42.9	163	119	46	18	14	18	84	38.1	15.9	22.2				206-19		
206-20	1 1/4 S																206-20		
SUCTP 207-20	1 1/4																SUC 207-20		
207-21	1 5/16																207-21		
207-22	1 3/8		1 7/8	6 5/8	5	2 29/32	23/32	9/16	11/16	3 11/16	1.6890	0.6890	1.0000	1/2			207-22	TP 207	1.7
207		35	47.6	168	127	48	18	14	18	94	42.9	17.5	25.4				207		
207-23	1 7/16																207-23		
SUCTP 208-24	1 1/2																SUC 208-24		
208		40	1 15/16	7 1/4	5 1/16	2 1/8	23/32	9/16	25/32	3 29/32	1.9370	0.7480	1.1890	1/2			208	TP 208	2.2

CUCTP with Hard Chrome Coated Bearing Inserts

CUCTP 204-12	3/4																CUC 204-12		
204		20	1 5/16	5	3 3/4	1 1/2	9/16	7/16	9/16	2 19/32	1.2205	0.5000	0.7205	3/8			204	TP 204	.8
CUCTP 205-14	7/8																CUC 205-14		
205		25	1 7/16	5 1/2	4 1/8	1 1/2	9/16	7/16	9/16	2 13/16	1.3386	0.5630	0.7756	3/8			205	TP 205	.8
205-16	1		36.5	140	105	38	14	11	14	71	34.0	14.3	19.7				205-16		
CUCTP 206-18	1 1/8																CUC 206-18		
206		30	1 11/16	6 13/32	4 11/16	1 13/16	23/32	9/16	11/16	3 19/64	1.5000	0.6260	0.8740	1/2			206	TP 206	1.2
206-19	1 3/16		42.9	163	119	46	18	14	18	84	38.1	15.9	22.2				206-19		
206-20	1 1/4 S																206-20		
CUCTP 207-20	1 1/4																CUC 207-20		
207-22	1 3/8																207-22		
207		35	1 7/8	6 5/8	5	2 29/32	23/32	9/16	11/16	3 11/16	1.6890	0.6890	1.0000	1/2			207	TP 207	1.7
207-23	1 7/16		47.6	168	127	48	18	14	18	94	42.9	17.5	25.4				207-23		
CUCTP 208-24	1 1/2																CUC 208-24		
208		40	1 15/16	7 1/4	5 1/16	2 1/8	23/32	9/16	25/32	3 29/32	1.9370	0.7480	1.1890	1/2			208	TP 208	2.2

BUCTP with Black Oxide Bearing Inserts

BUCTP 201-8	1/2																BUC 201-8		
202-10	5/8		1 5/16	5	3 3/4	1 1/2	9/16	7/16	9/16	2 19/32	1.2205	0.5000	0.7205	3/8			202-10	TP 204	.8
204-12	3/4		33.3	127	95	38	14	11	14	66	31.0	12.7	18.3				204-12		
204		20															204		
BUCTP 205-14	7/8																BUC 205-14		
205		25	1 7/16	5 1/2	4 1/8	1 1/2	9/16	7/16	9/16	2 13/16	1.3386	0.5630	0.7756	3/8			205	TP 205	.8
205-16	1		36.5	140	105	38	14	11	14	71	34.0	14.3	19.7				205-16		
BUCTP 206-18	1 1/8																BUC 206-18		
206		30	1 11/16	6 13/32	4 11/16	1 13/16	23/32	9/16	11/16	3 19/64	1.5000	0.6260	0.8740	1/2			206	TP 206	1.2
206-19	1 3/16		42.9	163	119	46	18	14	18	84	38.1	15.9	22.2				206-19		
206-20	1 1/4 S																206-20		
BUCTP 207-20	1 1/4																BUC 207-20		
207-22	1 3/8																207-22		
207		35	1 7/8	6 5/8	5	2 29/32	23/32	9/16	11/16	3 11/16	1.6890	0.6890	1.0000	1/2			207	TP 207	1.7
207-23	1 7/16		47.6	168	127	48	18	14	18	94	42.9	17.5	25.4				207-23		
BUCTP 208-24	1 1/2																BUC 208-24		
208		40	1 15/16	7 1/4	5 1/16	2 1/8	23/32	9/16	25/32	3 29/32	1.9370	0.7480	1.1890	1/2			208	TP 208	2.2