

# SELECTION/DIMENSIONS

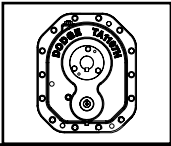

## TORQUE-ARM II Shaft Mount Speed Reducers

### TAPER BUSHED REDUCERS - TA9415H, DOUBLE REDUCTION

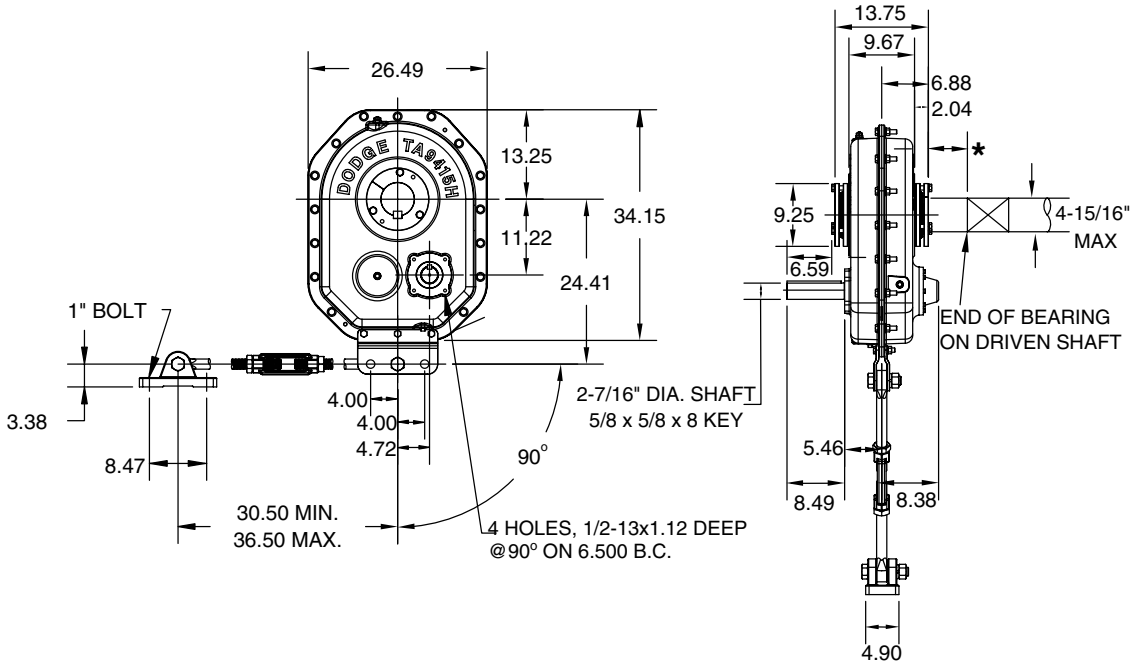

\* 2.39" MINIMUM DISTANCE FOR BUSHING SCREW REMOVAL

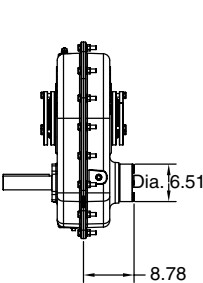

REDUCER WITH BACKSTOP

FLANGE MOUNTING DIMENSIONS

EASY SELECTION PAGE 9	SELECTION PAGE 12	RELATED PRODUCTS PAGE 123	ENGINEERING/TECHNICAL PAGE 129
--------------------------	----------------------	------------------------------	-----------------------------------

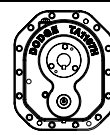

# SELECTION/DIMENSIONS

## TORQUE-ARM II Shaft Mount Speed Reducers

### TAPER BUSHED REDUCERS - TA9415H, DOUBLE REDUCTION

#### TA9415H Taper Bushed Reducers <sup>(1)</sup>

Reducer Size	Part Number	AGMA Code	Actual Ratio	Weight lbs.
TA9415H15	<b>909002</b>	415D15	15.10	735.0
TA9415H25	<b>909001</b>	415D25	25.44	735.0
TA9415H40	<b>909000</b>	415D40	39.41	732.0

- (1) Reducers are supplied from stock ready for vertical mounting and for flange mounting. Rod assembly is not included with reducer. Order as a separate part number.

#### TA9415H Accessories

Description	Part Number	Weight lbs.
TA9415RA Rod Assembly <sup>(1)</sup>	<b>909109</b>	76.8
TA9415BS Backstop Assembly <sup>(2)</sup>	<b>909102</b>	20.0
TA7315/9415BS 40:1 Backstop Assembly <sup>(2)</sup>	<b>907103</b>	21.0
TA9415MM Motor Mount Assembly (254-445T) <sup>(3)</sup>	<b>909090</b>	273.7
TA9415BG Belt Guard - Pos. B (254-445T)	<b>909096</b>	158.1
TA9415CF Cooling Fan Assembly	<b>909106</b>	12.4
TA4-TA12 Vertical Breather Kit	<b>904112</b>	3.0
Filter Breather Kit	<b>430049</b>	0.2

- (2) See page 129 for input shaft speed necessary for backstop sprag lift-off
- (3) Motor Mount will fit NEMA and IEC frame motors; however hardware are inch dimensions
- See page 122 for cooling fan dimensions

#### TA9415H Tapered Bushing Kits <sup>(5) (6)</sup>

Bushing Size	Part Number	Weight lbs.	Shaft Keyseat Required <sup>(9) (10)</sup>	Bushing Size	Part Number	Weight lbs.	Shaft Keyseat Required <sup>(9) (10)</sup>
Standard Shaft Bushing Kit	(7)			Short Shaft Bushing Kit <sup>(8)</sup>			
TA9415TB x 4-15/16 ▲	<b>909020</b>	38.4	1-1/4 x 5/8 x 13.74	TA9415TBS x 4-15/16	<b>909025</b>	40.2	1-1/4 x 5/8 x 8.56
TA9415TB x 4-7/16	<b>909021</b>	43.4	1 x 1/2 x 13.74	TA9415TBS x 4-7/16	<b>909026</b>	48.8	1 x 1/2 x 8.56
TA9415TB x 4-3/16	<b>909022</b>	46.4	1 x 1/2 x 13.74	TA9415TBS x 4-3/16	<b>909027</b>	53.4	1 x 1/2 x 8.56
TA9415TB x 3-15/16	<b>909023</b>	49.2	1 x 1/2 x 13.74	TA9415TBS x 3-15/16	<b>909028</b>	57.7	1 x 1/2 x 8.56
TA9415TB x 3-7/16	<b>909024</b>	53.1	7/8 x 7/16 x 13.74	TA9415TBS x 3-7/16	<b>909029</b>	64.4	7/8 x 7/16 x 8.56

#### ▲ AGMA maximum bore size

- (5) Bushing kit required to mount TA II reducer to driven shaft
- (6) (Bushing Kit is not required to mount TA II reducer on SCS Drive Shaft in a screw conveyor application
- (7) Standard Shaft Bushing Kit includes two standard bushings with backup plates and snap rings; hardware and one key
- (8) Short Shaft Bushing Kit includes one standard bushing; one long bushing with mounting wedge; two backup plates with snap rings; hardware and one key. This is an optional bushing for after market, short shaft mounting.
- (9) Minimum keyseat and shaft length required to mount reducer with bushing kit
- (10) Always check the driven shaft and key for strength