

Covers and Replacement Chain



CHAIN COUPLING COVERS

Chain Coupling Covers extend the life of the couplings by providing continuous lubrication and protection from abrasive and corrosive conditions. They are fitted with Neoprene seals, standard 1/8" pipe plugs and "Nyloc" cap screws, and fit all chain couplings — finished bore, minimum bore, split taper bushing type and taper bore bushing type.

CAUTION - Chain Coupling Covers should not be operated at speeds exceeding 5000 FPM rim speed.

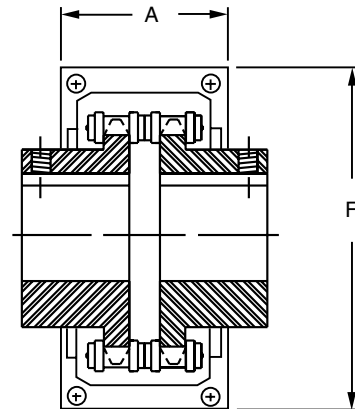

Table No. 7

Aluminum Covers

Cover Part No.*	Coupling Ref. No.	Dimensions (inches)		Wt. Lbs.	Accessory Kit**	
		A	F		Part No.	Wt. Lbs.
AL40	C4012	2	4	0.75	AL4012AK	0.2
	C4016				AL4016AK	0.2
AL4020	C4020	2 3/8	5 1/8	1.25	AL5020AK	0.3
AL50	C5016	2 3/8	5 1/8	1.25	AL5016AK	0.3
	C5018				AL5018AK	0.3
AL60	C6018	2 15/16	6 3/8	2.25	AL6018AK	0.5
	C6020				AL6020AK	0.5
AL80	C8018	4	8 3/16	4.50	AL8018AK	0.7
	C8020				AL8020AK	0.7
AL100	C10018	5 1/4	10 1/8	12.25	AL10018AK	1.0
	C10020				AL10020AK	1.0

* Cover includes 2 cover halves, 4 seals (except 2 seals for AL4020), gaskets and all necessary hardware for installation.

** Accessory Kit includes 2 seals for specified hub, 2 gaskets and all necessary hardware for reinstallation.

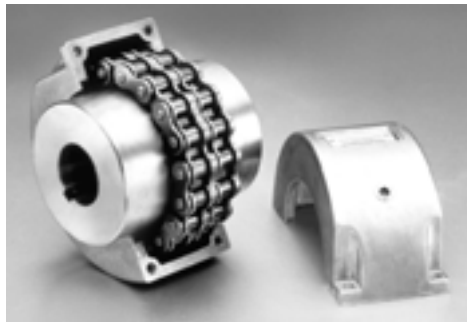

Chains for Couplings

Table No. 8

Coupling Ref. No.	Chain Part No.	Wt. Lbs.
C4012	C4012	0.4
C4016	C4016	0.5
C4020	C4020	0.7
C5016	C5016	1.2
C5018	C5018	1.3
C6018	C6018	2.2
C6020	C6020	2.6
C8018	C8018	5.3
C8020	C8020	5.9
C10018	C10018	9.8
C10020	C10020	10.9

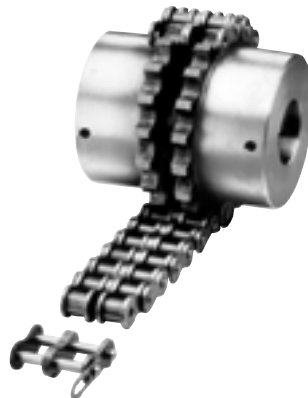

REPLACEMENT CHAIN

Replacement chains of correct length for each stock coupling are available from stock, individually packaged and complete with connecting links.